

ATHOLL PALACE
MAP

Enjoy an unforgettable stay at the Atholl Palace Hotel. 50 acres of mixed woodland and romantic gardens to explore, a rich heritage to discover in our museum and much more for families and visitors to experience within our estate and hotel.

In every season, a warm welcome awaits.

OPENING HOURS

Gardens Daylight hours
Museum 10am - 5pm
£3 per adult - Free Children under 16
Free for hotel residents - Self guided

Lavender Spa 10am - 6pm
& Gym 7am - 9pm (Mon-Fri)
7am - 7pm (Sat-Sun)

Stag's Head Bar 11am - 9pm (Food)
11am - close (Drinks)
Afternoon Tea 12:30pm - 4:00pm

Verandah 7:30 - 10am (Breakfast)
Restaurant 12:30 - 4:00 (Lunch)
6pm - 8pm (Dinner)

Check out 11am
WIFI Open Network "Atholl Palace Wifi"
Dial 0 for reception / Luggage storage available

+44 (0) 1796472400
www.athollpalace.com

Atholl Palace Hotel, Perth Road, Pitlochry, PH16 5LX, Scotland.



GROUND FLOOR

RELAX – DINE – INDULGE – EXPERIENCE

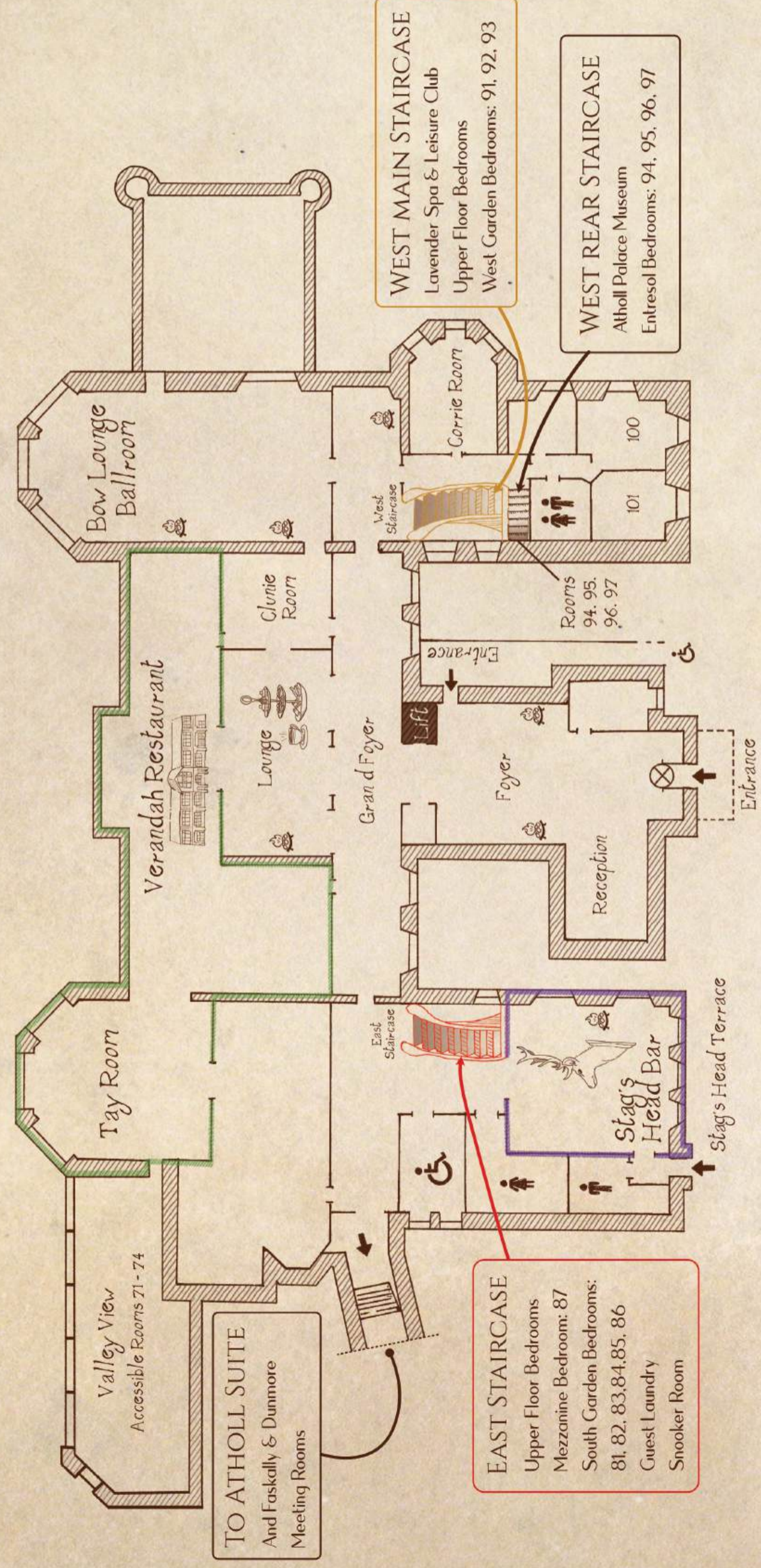
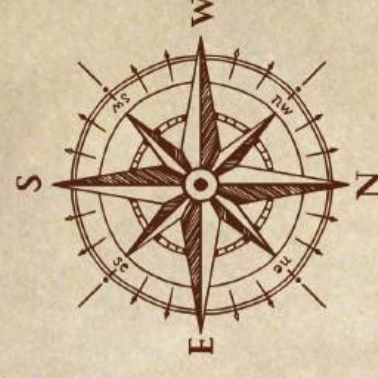

WEST MAIN STAIRCASE
Lavender Spa & Leisure Club
Upper Floor Bedrooms
West Garden Bedrooms: 91, 92, 93

WEST REAR STAIRCASE
Atholl Palace Museum
Entresol Bedrooms: 94, 95, 96, 97

EAST STAIRCASE
Upper Floor Bedrooms
Mezzanine Bedroom: 87
South Garden Bedrooms:
81, 82, 83, 84, 85, 86
Guest Laundry
Snooker Room

LOWER GROUND FLOOR

LAVENDER SPA – LEISURE CLUB – ATHOLL PALACE MUSEUM – GARDEN BEDROOMS

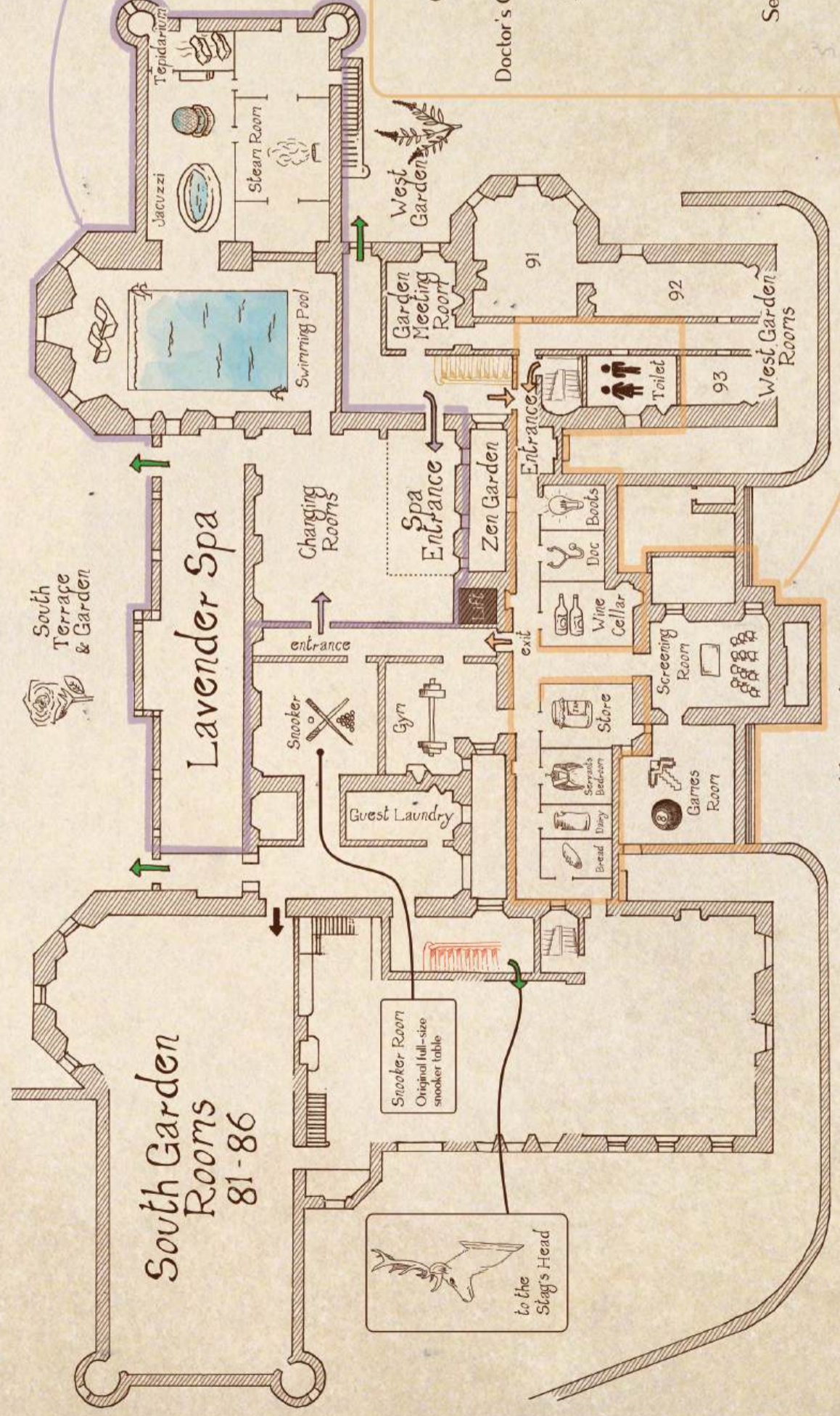

LAVENDER SPA
Swimming Pool, Jacuzzi, Steam Room and Gym are all available during your stay.
Spa treatments are available to book between 10am-6pm each day for an extra charge.
Telephone - 01796 473 777

MUSEUM KEY:
Our one of a kind museum explores the history of our grand hotel
Books Lights up a collection of hotel artifacts
Doctor's Consulting Room Health & hydro hotels in Victorian times
Wine Cellar A temperance establishment no longer
Screening Room Entertaining 22 minute film charts the story of the Atholl Palace.
Games Room School days in war times & a virtual hotel in Minecroft to explore.
Store Original slate counters used for temporary exhibitions & events
Servants' Bedroom Where hotel workers lay their heads after a long day of service.
Dairy Butter making equipment from a bygone time

WELCOME TO THE ATHOLL PALACE

The Atholl Palace Hotel offers a range of facilities and activities for guests and day visitors to discover. We hope this map will help you to find them, enhancing your stay.

Built between 1874 and 1878, our Victorian hotel retains much of its charm including several staircases, doors and mezzanine floors. Our reception team will be happy to mark on your map the best staircases or pathways to take.

Families, for your convenience we have baby changing facilities beside our Stag's Head Bar, a Guest Laundry downstairs and a Bottle Preparation Room on the third floor.

Should you have any further questions please contact any member of our Atholl Palace team who will be happy to assist you.

Dial 0 for Reception

EAT AND DRINK

Great Food available daily in the Verandah Restaurant with view of the river valley and Black Spout Woods.

Sit back and relax in our Stag's Head Bar and Terrace with mountain views.

- Afternoon Tea
- Sunday Roast Lunch
- Light Lunches
- Pre Theatre
- Valley View Lunch/ Dinner
- Children's Menus
- Wide Selection of Scottish Whisky and Gin
- Coffee/ Tea

Book Now: 01796472400 / info@athollpalace.com

EXPLORE – PLAY – RELAX – REVITALISE



ATHOLL PALACE GARDENS

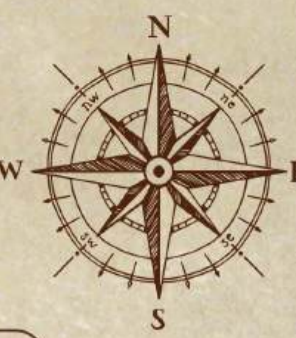

GLORIOUS GARDENS

'50 Acres to Explore'

Our 50 acre estate, originally landscaped by Mr Gorrie in 1874, is a short stroll from the picturesque town of Pitlochry, in the heart of Perthshire. Recreating the glorious gardens and relaxing atmosphere that were part of the original vision for the Atholl Palace has been our passion.

'Undiscovered Arboretum'

The remarkable specimen trees, planted as the hotel was being built, have been described as 'an undiscovered arboretum' and include Douglas Fir, Western Red Cedar and a Giant Sequoia. These fine big trees happily sit alongside an outcrop of ancient woodland oaks and more formal gardens such as the Japanese Garden, Front Lawn and Herbaceous border and the South Terrace Garden.

Our gardeners' hard work and imaginative planting has been celebrated with several prizes from the Pitlochry in Bloom competition over the last few years.

* Guide dogs only. Thank You.

OUR LODGES

Dotted around the estate we have a collection of luxury self catering cottages, lodges and apartments. There's the iconic Gate Lodge with its turrets or the magnificent Manor House that stood on Cnoc Faire before the Atholl Palace was built.

Tucked away are the other gems such as the Sweet Pea and Garden Cottage, which make the perfect romantic getaway. The Art Deco Highways building, perched overlooking the walled garden allows for large families to spend quality time together.

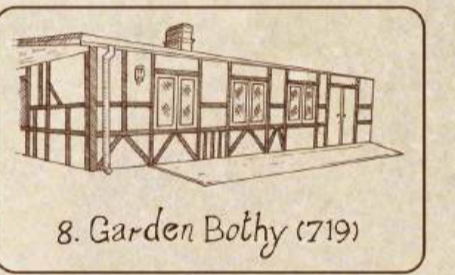
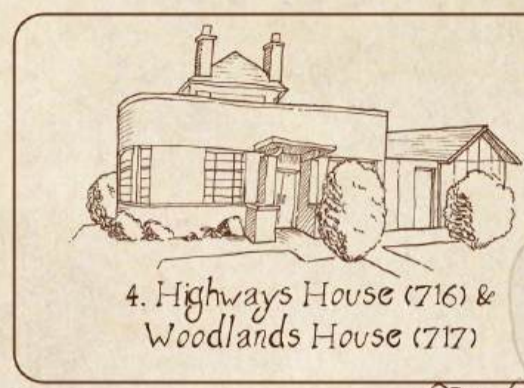

The champion tennis courts are perfect excuse for some friendly competition!
*Tennis equipment available at reception

Located a short walk from the hotel, please ask reception for directions.
*Putting Green equipment available at reception

Located a short walk from the hotel, please ask reception for directions.
*Pitch 'n' Putt equipment available at reception

THINGS YOU MIGHT FIND IN THE ESTATE:



DISCOVER PERTHSHIRE'S BIG TREE COUNTRY

Interpretation Boards found throughout the estate:

- A Giant Sequoia Wellingtonia
- B Birch
- C Wild Bank
- D Noble Fir
- E Rhododendrons
- F Coastal Redwood
- G Red Squirrel
- H Highways
- I Ancient Woodland
- J Roe Deer
- K Kitchen Herb Garden
- L Lovers Lane
- M Douglas Fir
- N Snowdrops

